

CERTIFICATE OF LAND

File No. 1099

Date: 08.07.25

Certified that the land measuring 12140.57 sq mt. (3 acres) is owned by the TATA STEEL by way of Lease Deed Agreement 2005 and further it was given to COUNCIL OF SCIENTIFIC AND INDUSTRIAL RESEARCH (CSIR) vide Letter No. TA/S20D/6953 dated 25.12.1999 (In case of allotment of land, if it is not perpetual, periodicity of allotment to be mentioned). Again it was given to NML KERALA PUBLIC SCHOOL, BHUIYADIH, AGRICO NEAR LITTI CHOWK, PIN 831009, JAMSHEDPUR, EAST SINGHBHUM, JHARKHAND vide agreement deed No. 1382 dt. 22.03.2013 for a period of 30 years with respect to date of signing.

It is further certified that leased owner subleased the said land to COUNCIL OF SCIENTIFIC AND INDUSTRIAL RESEARCH (CSIR) and it was given to NML KERALA PUBLIC SCHOOL, BHUIYADIH, AGRICO NEAR LITTI CHOWK, PIN 831009, JAMSHEDPUR, EAST SINGHBHUM, JHARKHAND (Name of the School/Society/Trust/Company under Section 8 of companies Act, 2013) vide agreement deed No. 1382 dt. 22.03.2013 fully described in the schedule mentioned hereinafter with the following details for a period of 30 years with respect to date of signing of the agreement.

Sl. No.	Particulars	Details
1.	Plot No.(s) Survey No.(s)/ Khasra No.(s)/ Khata No.(s)/ Khatauni No.(s)	Khata No. 218, Plot No. 2421, 2359, 3241
2.	Name of street/village, Sub Division, District and State	Mouja- Sakchi, Dist- East Singhbhum

It is certified that the said entire land comprise of a single Continuous plot of land. It is further certified that NML KERALA PUBLIC SCHOOL, BHUIYADIH, AGRICO NEAR LITTI CHOWK, PIN 831009, JAMSHEDPUR, EAST SINGHBHUM, JHARKHAND (Name of the School with name of street, village, sub-division and district) run by name of NML KERALA PUBLIC SCHOOL, BHUIYADIH, AGRICO NEAR LITTI CHOWK, PIN 831009, JAMSHEDPUR, EAST SINGHBHUM, JHARKHAND (Society / Trust / Company under Section 8 of companies Act, 2013) is located on the said plot of land.

THE SCHEDULED OF LAND ABOVE REFERRED TO

All that piece and parcel of land measuring 12140.57 sq mt. (3 acres) (area of land in square meters) situated in Plot No. 2421, 2359, 3241 at BHUIYADIH, AGRICO NEAR LITTI CHOWK, PIN 831009, JAMSHEDPUR, EAST SINGHBHUM, JHARKHAND and bounded as follows:

North : PART OF PLOT NO 166
 South : ROAD
 East : WATER PLANT OF TATA STEEL
 West : SEWAGE PLANT

DM/ ADM/ SDM/ TEHSILDAR/ NAIB TEHSILDAR/ REGISTRAR/ SUB- REGISTRAR/EQUIVALENT LAND AUTHORITY

[Signature]
 08/07/25
 (Stamp and Signature of the Land Authority)
 Circle Officer,
 Jamshedpur, (Name of Officer)
 (Name of District)

तुलनात्मक नक्शा

N
हाल सर्वे (काली रसाही)
नाम अधिसूचित क्षेत्र जमशेदपुर
वार्ड संख्या : 11, चादर सं० : 4
राजस्व थाना : घाटशिला
जिला : सिंहभूम
पैमाना : 1 सेमी० = 20 मीटर
S
सन् : 1970 - 71 ईस्वी

N
साबिक सर्वे (लाल रसाही)
Sankchi (Jamshedpur)
मोजा साँकची
थाना घाटशिला
थाना न० 1153
तरफ आसनबन्दी
जिला सिंहभूम
पैमाना 32' = 1 मील
S
सन् : 1934-35 ईस्वी

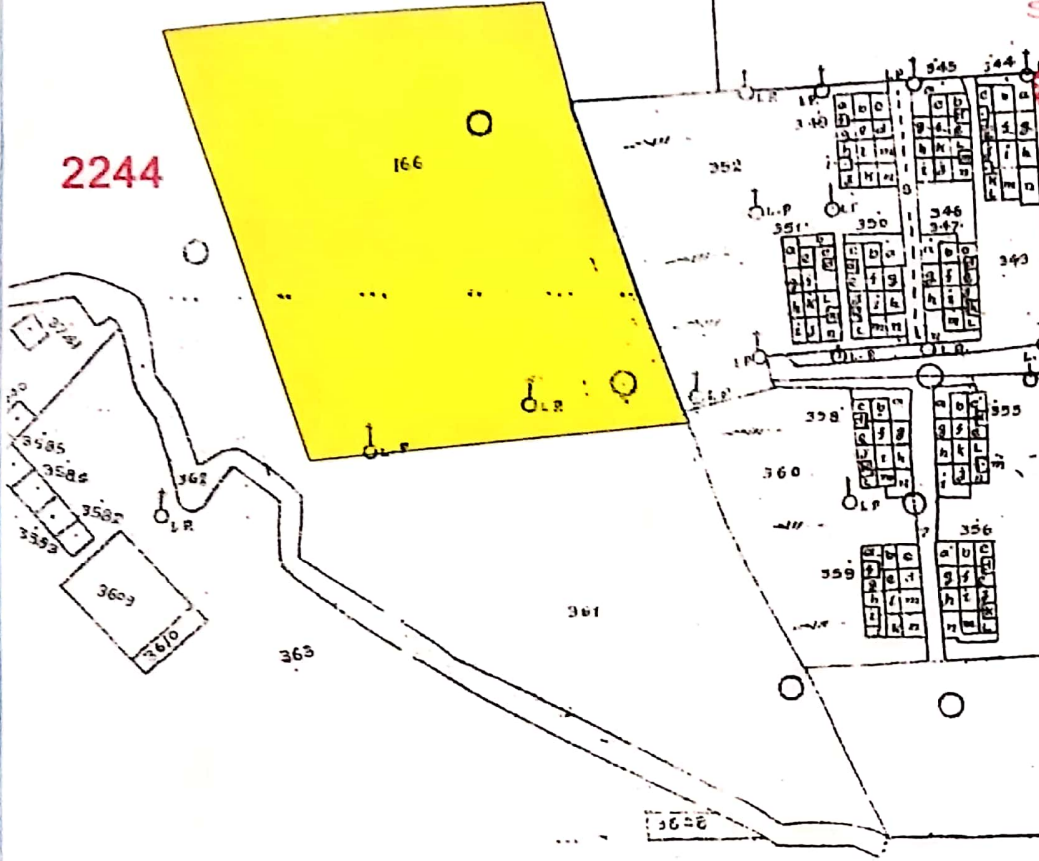

नोट - अनुमण्डल पदाधिकारी का कार्यालय, घालभूम, जमशेदपुर राजस्व शाखा का पत्रांक - 1588/रा० जमशेदपुर, दिनांक - 04/09/2023 के आलोक में इकरारनामा (एग्रीमेंट) संख्या - 1382 दिनांक - 22/03/2013 के अनुसार एन०एम०एल० केरला पब्लिक स्कूल, सा० - एग्रीको, जमशेदपुर अवस्थित भूखण्ड का विवरण :-

खाता सं०	खेसरा सं० (साबिक)	रकबा	चौहद्दी
-	2359	3 एकड़	उत्तर - भुइयाडीह वरती
-	2421		दक्षिण - एन०एम०एल० भूमि
-	3241		पूरब - ऑक्सीजन कॉलोनी पश्चिम - भुइयाडीह वरती

वर्तमान चौहद्दी :-

30 - खाता संख्या 166 का अंश,
40 - रास्ता
50 - Water supply plant
60 - मइशिन रॉकी (servoj plant)

संकेत :-



★ तुलनात्मक नक्शानुसार सरजमीन जॉचोपरान्त पाया गया भूखण्ड का विवरण :-

खाता सं०	खेसरा सं०	रकबा	चौहद्दी
हाल - 52	166 अंश	198.7 डी०	उत्तर - खेसरा सं० 166 अंश
हाल - 52	361 अंश	101.30 डी०	दक्षिण - खेसरा सं० 361 अंश
साबिक -	2244 अंश	300 डी०	पूरब - खेसरा सं० 166 अंश व 352
		या 3 एकड़	पश्चिम - खेसरा सं० 166 अंश व 361 अंश

अंचल अमीन
कार्यालय, डुमरिया

प्रमाणित किया जाता है कि हाल सर्वे नक्शा 1970-71 ईस्वी(फोटो-कॉपी) के आधार पर ट्रेस किया गया है।

अमीन

जमशेदपुर